

MAIN FLOOR PLAN

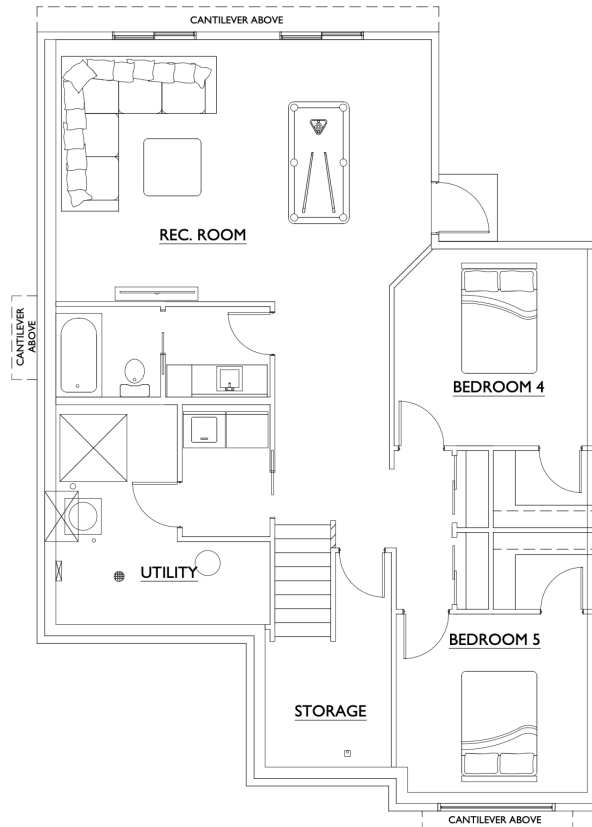

BASEMENT PLAN



# HOLDEN 44 HANLON

Bi-Level

Double Car Attached Garage  
Walkout Finished Basement

Square Feet  
1,375

Bedrooms

5

Bathrooms

3

204-728-2235  
[www.jandghomes.ca](http://www.jandghomes.ca)



**RE/MAX**  
VALLEYVIEW REALTY



**J&GHomes**  
customized lifestyles